

PUNJAB STATE TRANSMISSION CORPORATION LTD.

(NOTICE INVITING TENDER)

Office of	:	Add. S.E. 400/220 KV S/S Dhuri (Bhalwan)
Tender Notice	:	Cleaning & Sweeping of Roads, Open Spaces, Switchyards Roads, Horticulture work and Cleaning of Office Building at 400/220 KV S/S Dhuri Bhalwan
Tender Enquiry No.	:	03/2015-2016
Estimated Cost	:	Rs. 17.00 Lacs
Cost of Specification	:	Rs. 500/- Demand Draft in favor of PSTCL / Cash Receipt of PSTCL for purchase of Tender Documents.
Last Date & Time for		
1. Sale of Tender Document	:	Upto 18-05-2015 5.00 P.M
2. Receipt of Tenders	:	19-05-2015 at 12.00 a.m
3. Opening of Tenders	:	19-05-2015 at 12.30 a.m
Earnest Money	:	Rs.34000/- in cash or shape of demand draft in favour of PSTCL.

- 1) The undersigned reserve the right to reject any or all the tenders so received without assigning any reason.
- 2) Tender received telegraphically/Fax/Conditional Tenders without earnest money shall not be accepted.
- 3) Please do not forget to super scribe the envelop(s) with the name tender and due date of opening of tender.
- 4) Tender Called on Dated 02-03-2015 is rejected due to technical reasons.

Addl. S.E.
400/220 KV S/S
Dhuri (Bhalwan)

ਪੰਜਾਬ ਸਟੇਟ ਟਰਾਂਸਮਿਸ਼ਨ ਕਾਰਪੋਰੇਸ਼ਨ ਲਿਮਿਟਡ
(ਟੈਂਡਰ ਮੰਗਣ ਦੀ ਨੋਟਿਸ)

ਦਫਤਰ ਦਾ ਨਾਂ	ਵਧੀਕ ਨਿਗਰਾਨ ਇੰਜੀਨੀਅਰ 400/220 ਕੇ.ਵੀ.ਸ/ਸ ਪੂਰੀ(ਭਲਵਾਨ)
ਟੈਂਡਰ ਦਾ ਵੇਰਵਾ	400 ਕੇ.ਵੀ. ਸਬ ਸਟੇਸ਼ਨ ਪੂਰੀ (ਭਲਵਾਨ) ਸੰਗਰੂਰ ਵਿਖੇ ਸੜਕਾਂ, ਖਾਲੀ ਥਾਵਾਂ, ਸਵਿੱਚ ਯਾਰਡ ਰੋਡ, ਬਾਗਬਾਨੀ ਦਾ ਕੰਮ ਅਤੇ ਦਫਤਰ ਦੀ ਬਿਲਡਿੰਗ ਦੀ ਸਾਫ ਸਫਾਈ ਲਈ।
ਟੈਂਡਰ ਨੰ:	03/2015-2016
ਟੈਂਡਰ ਦੀ ਕੀਮਤ	17.00 ਲੱਖ ਰੁਪਏ
ਸਪੈਸੀਫਿਕੇਸ਼ਨ ਦੀ ਕੀਮਤ	500/ ਰੁਪਏ ਕੈਸ਼ ਜਾਂ ਬੈਕ ਡਰਾਫਟ ਪੀ ਐਸ ਟੀ ਸੀ ਐਲ ਦੇ ਨਾਂ ਤੇ ਹੋਵੇ।
ਆਖਰੀ ਮਿਤੀ ਅਤੇ ਸਮਾਂ	
1 ਟੈਂਡਰ ਵੇਚਣ ਦੀ ਮਿਤੀ	18/05/2015 ਸਮਾਂ ਸ਼ਾਮ 5:00 ਵਜੇ ਤੱਕ
2 ਟੈਂਡਰ ਪ੍ਰਾਪਤੀ ਦੀ ਮਿਤੀ	19/05/2015 ਸਮਾਂ ਸਵੇਰੇ 12:00 ਵਜੇ ਤੱਕ
3 ਟੈਂਡਰ ਖੋਲ੍ਹਣ ਦੀ ਮਿਤੀ	19/05/2015 ਸਮਾਂ ਸ਼ਾਮ 12:30 ਵਜੇ
ਜਮਾਨਤੀ ਰਕਮ (ਅਰਨੈਸਟ ਮਨੀ)	340000/ ਰੁਪਏ ਕੈਸ਼ ਵਿੱਚ ਜਾਂ ਡੀਮਾਡ ਡਰਾਫਟ ਪੀ ਐਸ ਟੀ ਸੀ ਐਲ ਦੇ ਨਾਂ ਤੇ ਹੋਵੇ।

- ਹੋਰ ਲੋੜੀਂਦੀ ਸੂਚਨਾ ਪੀ ਐਸ ਟੀ ਸੀ ਐਲ ਦੀ ਵੈਬ ਸਾਈਟ www.pstcl.org ਤੇ ਪ੍ਰਾਪਤ ਕੀਤੀ ਜਾ ਸਕਦਾ ਹੈ।
- 1) ਨਿਮਨ ਹਸਤਾਖਰ ਕਰਤਾ ਕਿਸੇ ਵੀ ਟੈਂਡਰ ਨੂੰ ਜਾਂ ਸਾਰੇ ਹੀ ਟੈਂਡਰ ਨੂੰ ਬਿਨਾਂ ਕਾਰਨ ਦੱਸੇ ਰਦ ਕਰ ਸਕਦਾ ਹੈ।
 - 2) ਟੈਲੀਗ੍ਰਾਫ/ਫੈਕਸ ਰਾਹੀਂ/ ਕੰਡੀਸ਼ਨਲ ਟੈਂਡਰ ਜਾਂ ਬਿਨਾਂ ਅਰਨੈਸਟ ਮਨੀ ਦੇ ਪ੍ਰਾਪਤ ਹੋਏ ਟੈਂਡਰ ਰੱਦ ਕੀਤੇ ਜਾਣਗੇ।
 - 3) ਟੈਂਡਰ ਵਾਲੇ ਲਿਫਾਫੇ ਤੇ ਟੈਂਡਰ ਦਾ ਨਾਮ ਅਤੇ ਟੈਂਡਰ ਖੋਲ੍ਹਣ ਦੀ ਮਿਤੀ ਲਿਖਣਾ ਲਾਜ਼ਮੀ ਹੈ।
 - 4) ਮਿਤੀ 02, 03, 2015 ਨੂੰ ਕਾਲ ਕੀਤੇ ਟੈਂਡਰ ਤਕਨੀਕੀ ਕਾਰਨਾਂ ਕਰਕੇ ਰੱਦ ਕੀਤੇ ਜਾਦੇ ਹਨ।

 ਵਧੀਕ ਨਿਗਰਾਨ ਇੰਜੀਨੀਅਰ
 400/220 ਕੇ.ਵੀ. ਸਬ ਸਟੇਸ਼ਨ
 ਪੂਰੀ (ਭਲਵਾਨ)

Tender Enquiry no. 03/2015-16



DNIT FOR

" Cleaning & Sweeping of internal roads, open space in switch house buliding and switchyard roads, open spaces, office building & Cutting of grassy lawns, open spaces, parks, Weeding out grass small bushes etc. as per direction of Er.-In- Charge of 400/220 KV Sub - Station Dhuri Bhalwan complex."

OFFICE OF

Addl. S.E./400 KV
PSTCL, DHURI BHALWAN

Issued to:-

M/s _____

Addl. S.E./400 KV
PSTCL, DHURI BHALWAN

CONTANTS

Sr. no.	Description	Page no.
1	Contents	nil
2	Noting Inviting Tender :- i) <i>For publicity in the News Papers</i> ii) <i>For publicity on PSTCL Website</i>	
3	Section A - General terms & conditions	
	iii) Section I <i>Tendering and contract agreement</i>	1 to 4
	iv) Section II <i>General Condition of contract</i>	5 to 10
	v) Section III <i>Performance of the contract and payments.</i>	11 to 18
	iv) Section IV <i>Fair wage clause and labour regulations</i>	19 to 21
	vi) Section VI <i>Technical terms & conditions</i>	22
	vii) Section VII <i>Additional terms & conditions</i>	23 to 25
4	SECTION B <i>General notes regarding schedule of quantities and rates.</i>	26 to 27
5	Tender Form for quoted the rate bt Contractor included Drawings	Annexure - 'A'
6	Contract Agreement Form.	Annexure - 'A-II'

Annexure -A

Issued to :- _____

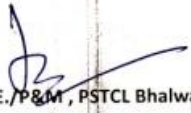
 Addl.S.E./P&M, PSTCL Bhalwan

Nature of Work :	Cleaning & Sweeping of Roads, Open Spaces, Switchyards, Horticulture work and Office Building and House keeping at 400/220 KV S/S Dhuri Bhalwan
Tender Enquiry No. & Date	03/2015-16
Date of publication in the website (www.pstcl.org) :	
Date of publication in the newspapers :	

Sr. No	Complete detail of Work	Rate/Month to be quoted by Contractor
1	Cleaning of Office Buliding, Transit Camp Complex, Roads in the Office Complex. (As per drawing enclosed).	
2	Cutting of grassy lawns, open spaces, parks, weeding out grass small bushes etc. in the 400 KV S/S Complex. (As per detail enclosed).	

Date of purchase of Tender	
Payment of tender Documents (BA-16 No/ Receipt No/ Date)	
Earnest Money Details	

Authorized Representative/Contractor

CONTRACT AGREEMENT

This contract agreement made this _____ day of _____ in the year _____ between the Punjab State Transmission Corporation Limited herein after called Purchaser and M/s _____ having their Regd. office at _____ herein after called contractor for the supply and delivery construction of _____ in accordance with Tender letter No. _____ dated _____.

This is an confirmations of the advance acceptances notified in the owner letter No. _____ Where in owner has accepted the proposal of the contract for the delivery/construction of _____ as per work order/Allotment order No. _____.

In view of the forgoing the purchase and the contractor have agreed to be the scope of work and the terms & conditions of the order settled between them.

The NIT./Tender specifications of the contractor proposal and related correspondence and the work order acknowledge accepted by the contractor form part of the agreement.

This agreement contains _____ pages. In witness thereof the parties here to have affixed their signature on the day, month and year written as above contractor.

Owner

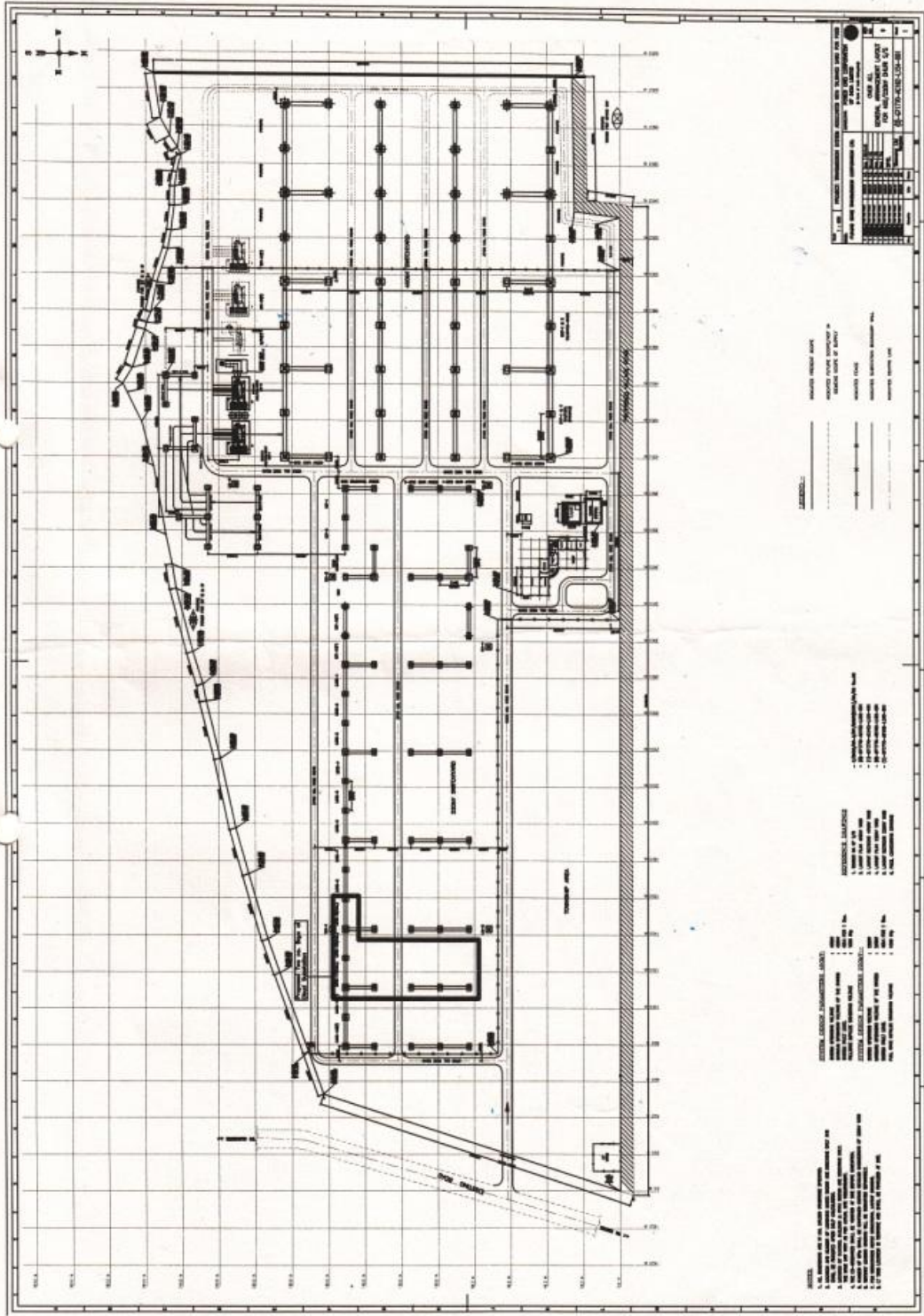

REVISIONS

NO.	DATE	DESCRIPTION
1	10/15/58	ISSUED FOR CONSTRUCTION
2	11/10/58	REVISIONS TO ELECTRICAL LAYOUT
3	12/15/58	REVISIONS TO MECHANICAL LAYOUT
4	01/10/59	REVISIONS TO STRUCTURAL LAYOUT
5	02/15/59	REVISIONS TO FINISHES
6	03/10/59	REVISIONS TO ELEVATIONS
7	04/15/59	REVISIONS TO DETAILS
8	05/10/59	REVISIONS TO SCHEDULE
9	06/15/59	REVISIONS TO SPECIFICATIONS
10	07/10/59	REVISIONS TO CONTRACT DOCUMENTS

LEGEND:

- STRUCTURAL STEEL
- CONCRETE
- MECHANICAL EQUIPMENT
- ELECTRICAL EQUIPMENT
- FINISHES
- ELEVATIONS
- DETAILS
- SCHEDULE
- SPECIFICATIONS
- CONTRACT DOCUMENTS

GENERAL NOTES:

1. ALL DIMENSIONS ARE IN FEET AND INCHES.
2. THE CONTRACTOR SHALL BE RESPONSIBLE FOR OBTAINING ALL NECESSARY PERMITS AND APPROVALS FROM THE LOCAL AUTHORITIES.
3. THE CONTRACTOR SHALL BE RESPONSIBLE FOR OBTAINING ALL NECESSARY MATERIALS AND LABOR.
4. THE CONTRACTOR SHALL BE RESPONSIBLE FOR OBTAINING ALL NECESSARY UTILITIES AND SERVICES.
5. THE CONTRACTOR SHALL BE RESPONSIBLE FOR OBTAINING ALL NECESSARY TRANSPORTATION AND LOGISTICS.
6. THE CONTRACTOR SHALL BE RESPONSIBLE FOR OBTAINING ALL NECESSARY INSURANCE AND BONDING.
7. THE CONTRACTOR SHALL BE RESPONSIBLE FOR OBTAINING ALL NECESSARY SAFETY AND HEALTH MEASURES.
8. THE CONTRACTOR SHALL BE RESPONSIBLE FOR OBTAINING ALL NECESSARY COMMUNICATIONS AND RECORDS.
9. THE CONTRACTOR SHALL BE RESPONSIBLE FOR OBTAINING ALL NECESSARY TRAINING AND EDUCATION.
10. THE CONTRACTOR SHALL BE RESPONSIBLE FOR OBTAINING ALL NECESSARY SUPPORT AND ASSISTANCE.

REFERENCE DRAWINGS:

1. ARCHITECTURAL DRAWINGS
2. STRUCTURAL DRAWINGS
3. MECHANICAL DRAWINGS
4. ELECTRICAL DRAWINGS
5. FINISHES DRAWINGS
6. ELEVATIONS DRAWINGS
7. DETAILS DRAWINGS
8. SCHEDULE DRAWINGS
9. SPECIFICATIONS DRAWINGS
10. CONTRACT DOCUMENTS DRAWINGS

DESIGNER: [Name]

DATE: [Date]

SCALE: [Scale]

PROJECT: [Project Name]

LOCATION: [Location]

CLIENT: [Client Name]

ARCHITECT: [Firm Name]

ENGINEER: [Firm Name]

MECHANICAL: [Firm Name]

ELECTRICAL: [Firm Name]

FINISHES: [Firm Name]

ELEVATIONS: [Firm Name]

DETAILS: [Firm Name]

SCHEDULE: [Firm Name]

SPECIFICATIONS: [Firm Name]

CONTRACT DOCUMENTS: [Firm Name]

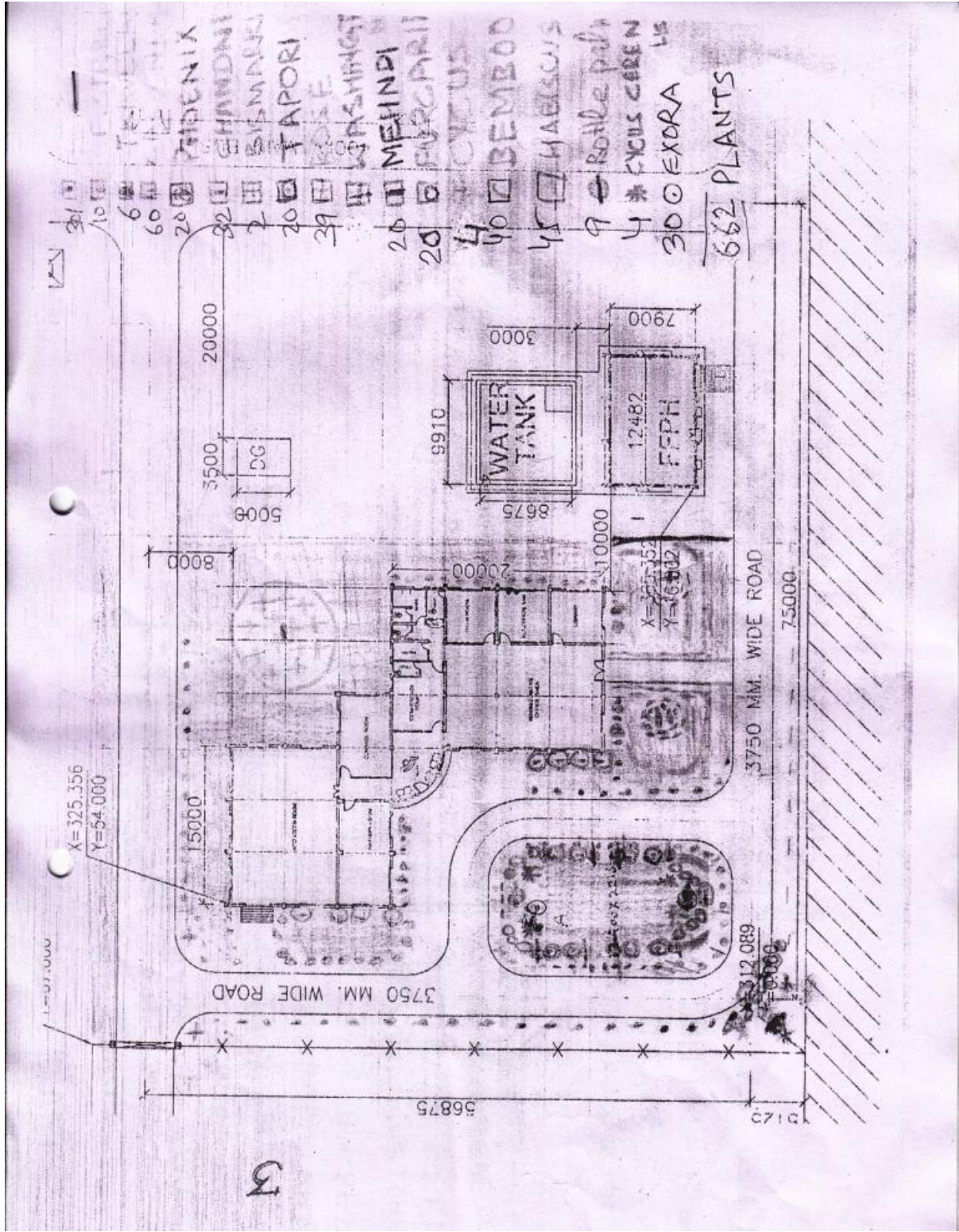

3

1

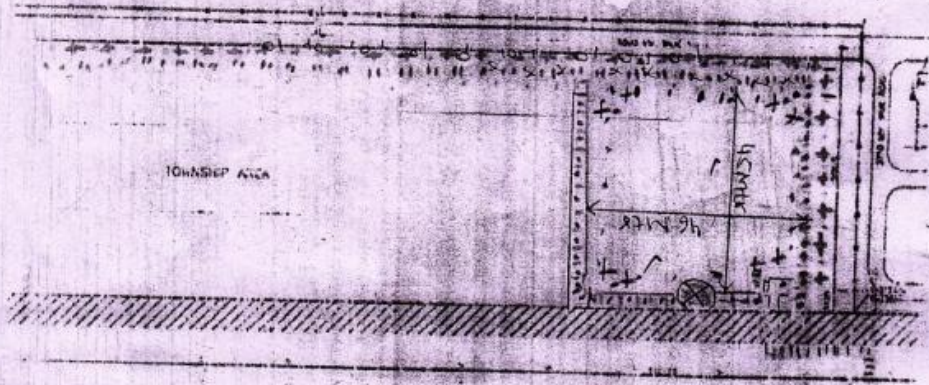

- 140 FIGUS BENJAMINI
- 41 FIGUS RIGNALI
- 34 BOTTLE PALM
- 32 LARGESTOMIA
- 143 HABISCUS
- 40 MEHINDI
- CONCRETESLAB
- 44 RAAT KI RANI
- 10 WASHINGTONIA
- GREEN HEDGE
- GREEN LAWN
- 55 OLENDER
- 46 SHUBRA
- 57 TMC VARGATED
- 2 CYCUS
- 61 ROSES

702 PL ANTS

②
DETAILED DRAWING OF ROAD SIDE

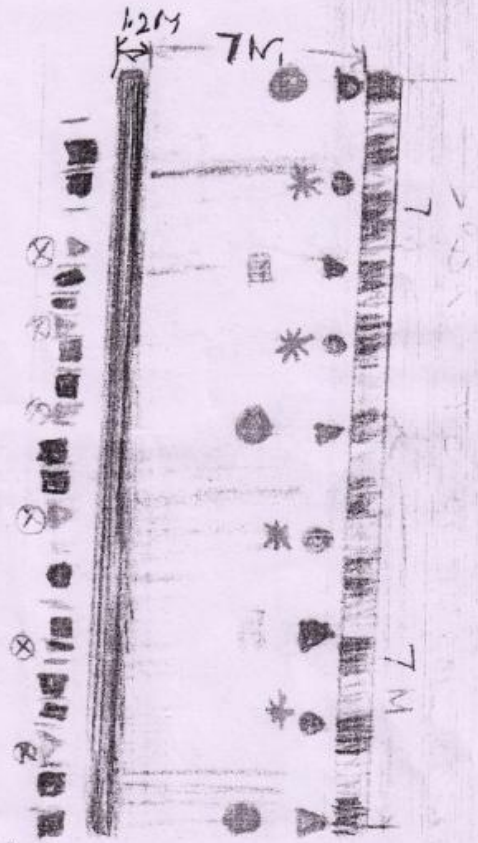

- | | |
|--------------------------------|-------------------|
| ★ WASHINGTONIA | □ HEDERA |
| ▲ SHUBRA | □ FICUS BENJAMINA |
| □ (with horizontal lines) ROSA | □ CHANDIVI |
| ● LITTLE PALM | □ RAAT KI RANI |
| □ (with vertical lines) GRASS | |
| ★ ROSE | |

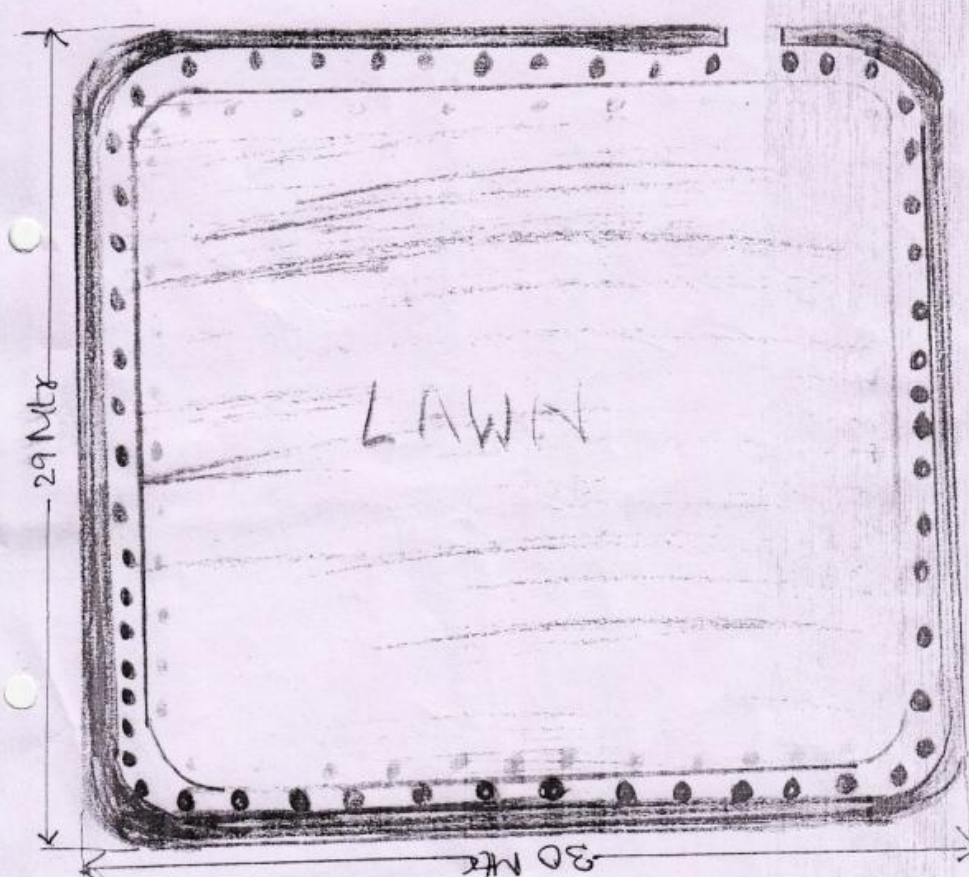

- GREEN HEDGE
- FICUS BENJAMINA
- FICUS PANDA
- GRASS